

RADITEK INC.

SAW Band Pass Filter for EGSM-RX Band 925MHz to 960MHz, 10 dBm Input Power, Surface Mount RSAW-BPF-925-960M-0303-10d-S-p2

code-p2

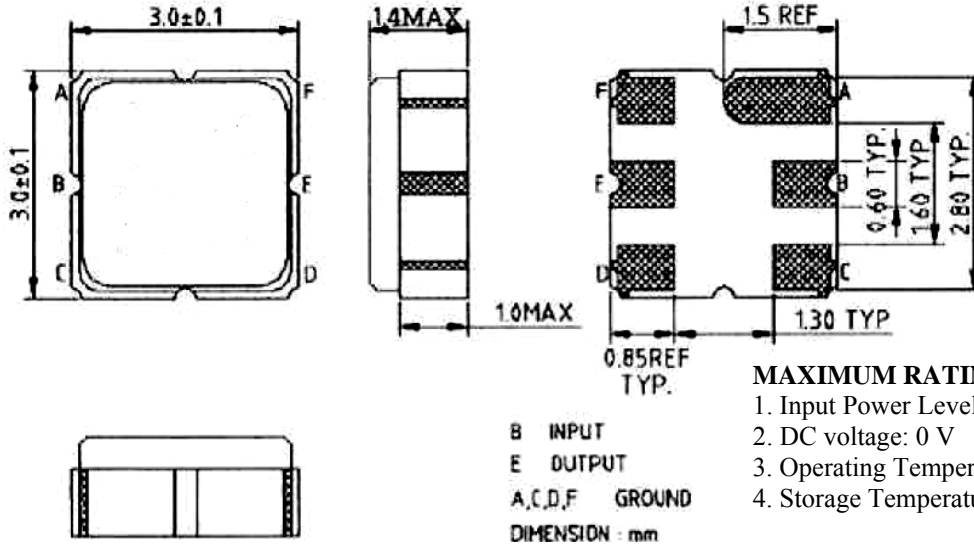

MAXIMUM RATING:

1. Input Power Level: 10 dBm
2. DC voltage: 0 V
3. Operating Temperature: -30°C to $+85^{\circ}\text{C}$
4. Storage Temperature: -40°C to $+85^{\circ}\text{C}$

Specifications	Unit	Minimu	Typical	Maximum
Center Frequency (F_c)	MHz	-	942.5	-
Insertion Loss (925 ~ 960 MHz)	dB	-	2.2	3.0
Amplitude ripple (925 ~ 960 MHz)	dB	-	0.8	1.5
Attenuation (Reference level from 0 dB):				
DC ~ 905 MHz	dB	17.0	20.5	-
905~915 MHz	dB	5.0	15.0	-
980 ~ 1000 MHz	dB	13.0	30.0	-
1000 ~ 2000 MHz	dB	20.0	23.0	-
VSWR (925 ~ 960 MHz)	-	-	2.2	2.7
Source Impedance	Z_s	Ω	50	-
Load Impedance	Z_L	Ω	50	-

Notes : (1) Note1. No matching network required for operation at 50Ω

RADITEK INC.

SAW Band Pass Filter for EGSM-RX Band 925MHz to 960MHz, 10 dBm Input Power, Surface Mount RSAW-BPF-925-960M-0303-10d-S-p2

code-p2

Frequency Characteristics : Transfer function

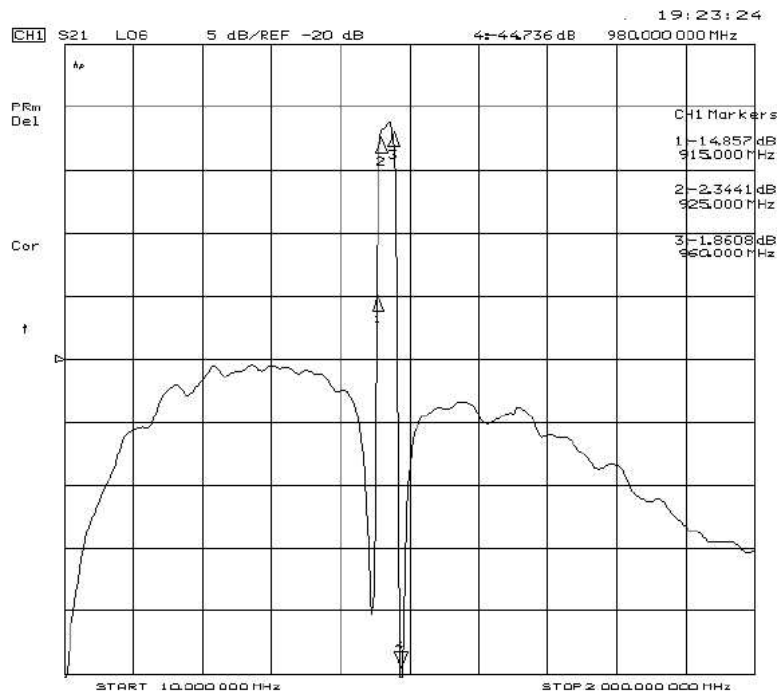
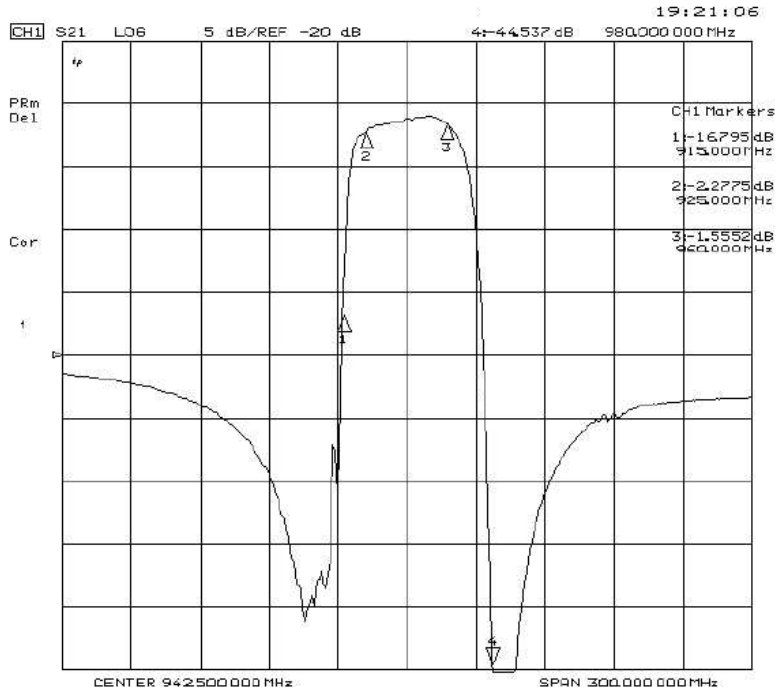

RSAW-BPF-925-960M-0303-10d-S-p2 **Specifications may be subject to change**

02/18/09

WORLD HQ: 1702L Meridian Ave. Suite 127, San Jose, Ca 95125, U.S.A.

Telephone: (408) 266-7404 FAX: (408) 266-4483

WEB: www.raditek.com, E-mail: sales@raditek.com

RADITEK INC.

SAW Band Pass Filter for EGSM-RX Band 925MHz to 960MHz, 10 dBm Input Power, Surface Mount RSAW-BPF-925-960M-0303-10d-S-p2

code-p2

S11 VSWR

Reflections function

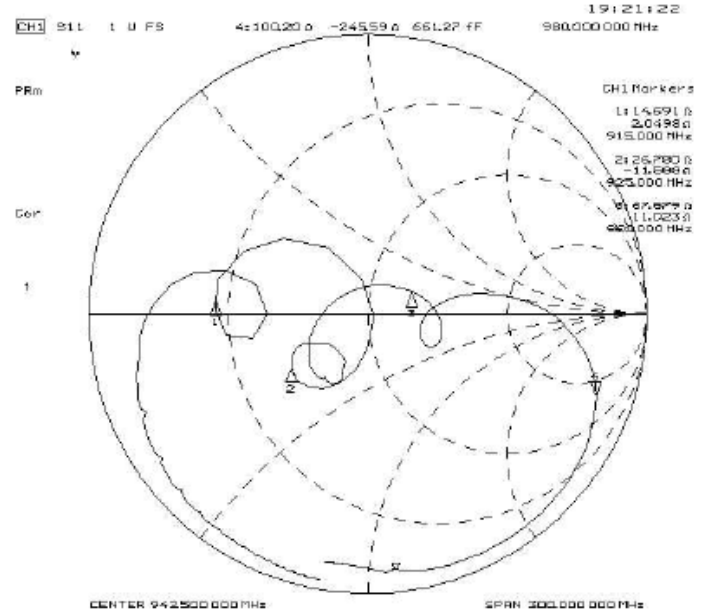
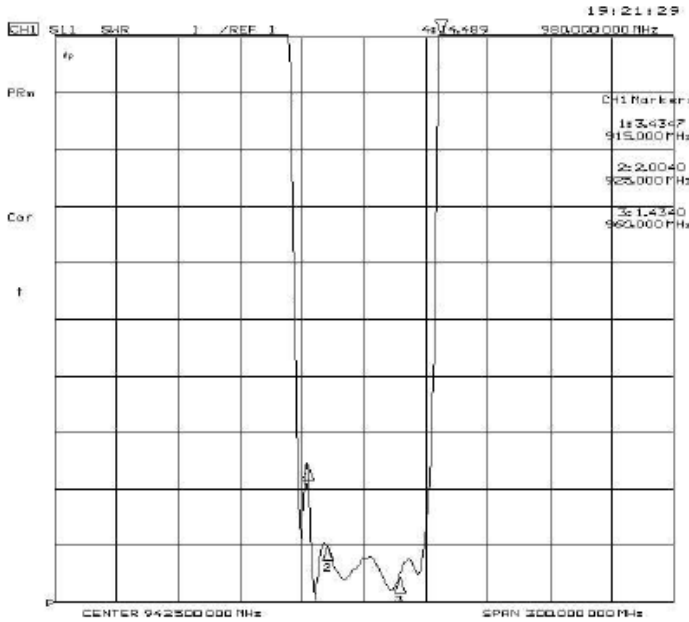

S22 VSWR

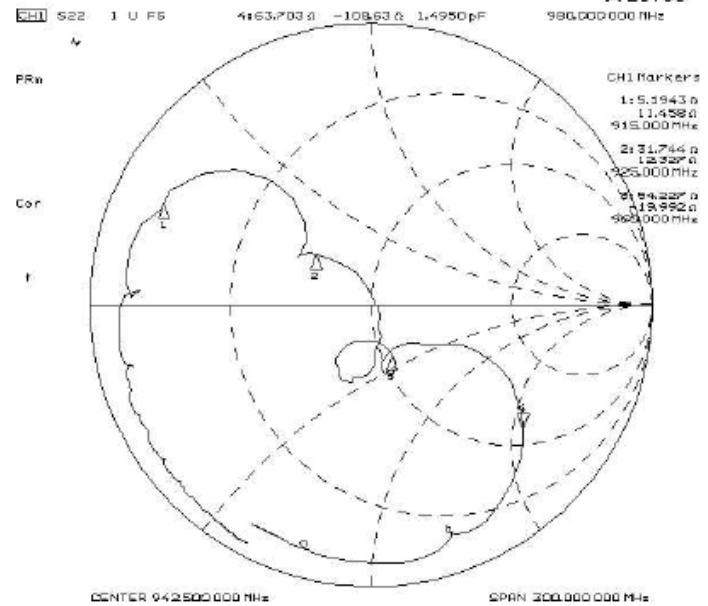
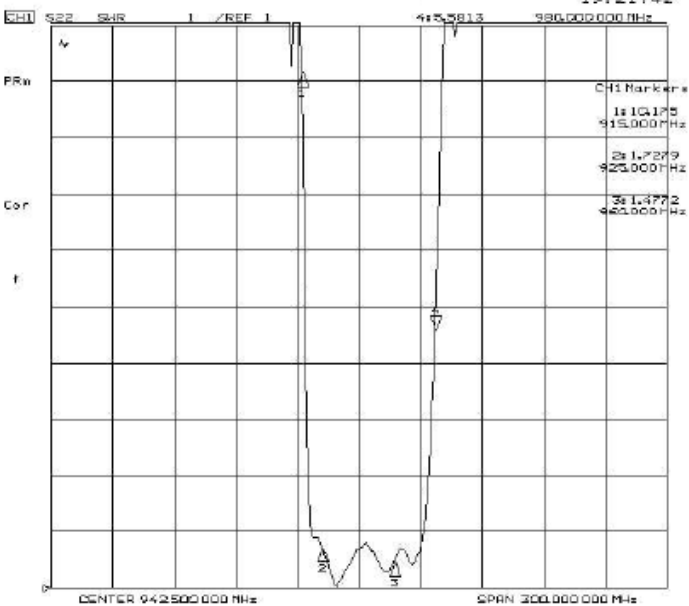

RADITEK INC.

SAW Band Pass Filter for EGSM-RX Band 925MHz to 960MHz, 10 dBm Input Power, Surface Mount RSAW-BPF-925-960M-0303-10d-S-p2

code-p2

MEASUREMENT CIRCUIT

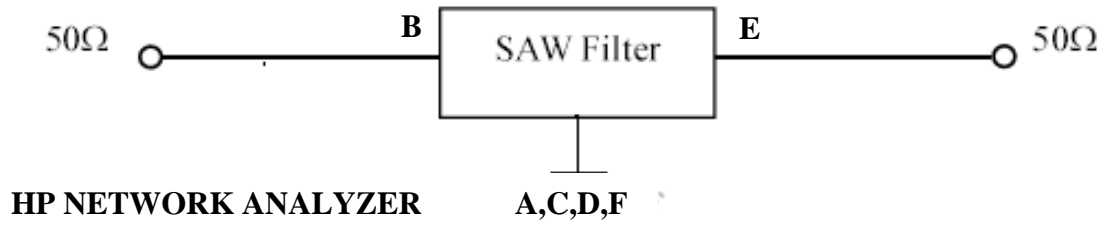

PCB FOOTPRINT

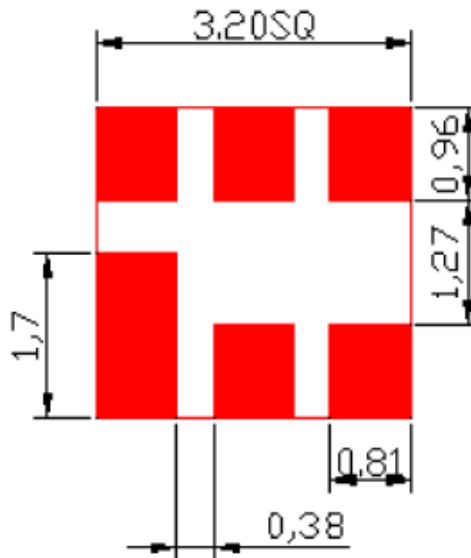

RADITEK INC.

SAW Band Pass Filter for EGSM-RX Band 925MHz to 960MHz, 10 dBm Input Power, Surface Mount RSAW-BPF-925-960M-0303-10d-S-p2

code-p2

REEL DIMENSION

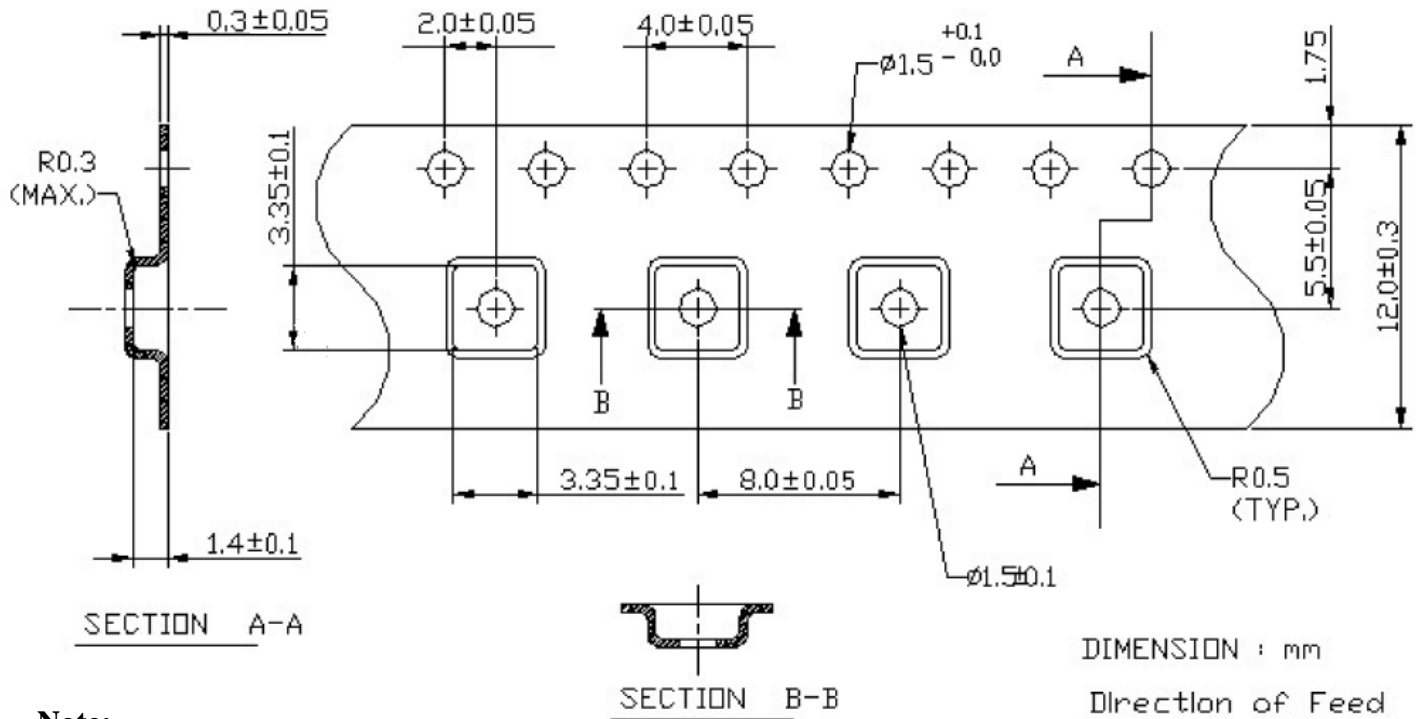
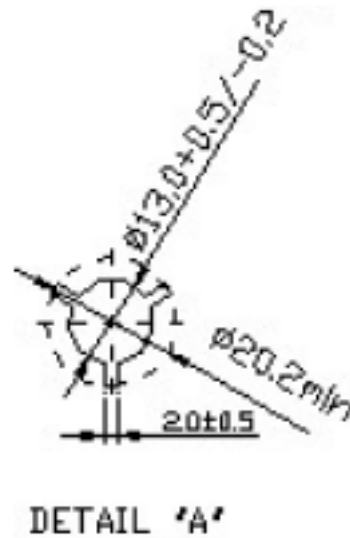
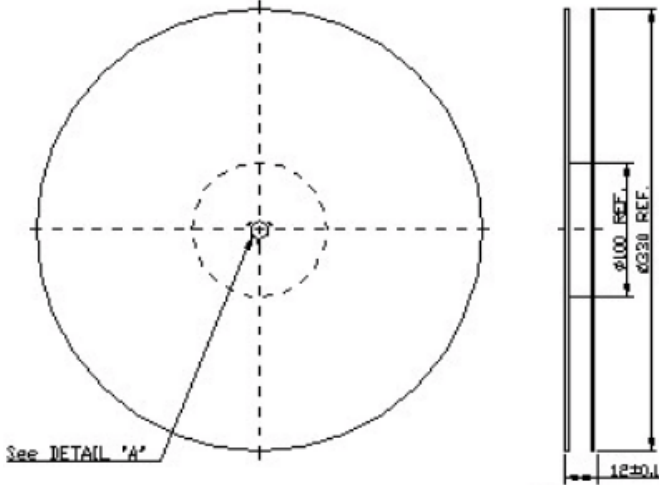

Note:

1. Pocket position relative to sprocket hole measured as true position of pocket, not pocket hole.