

Low Pass Filter, DC-12.4 GHz SMA Male to SMA Female Connectors, ≤ 15 Watts

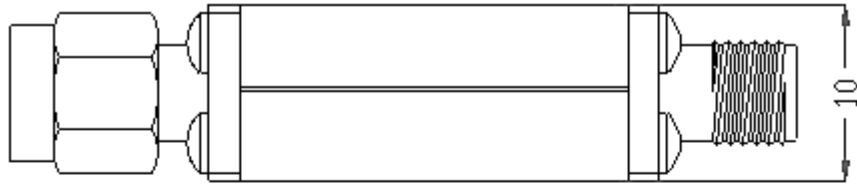

Units: mm
Not to scale

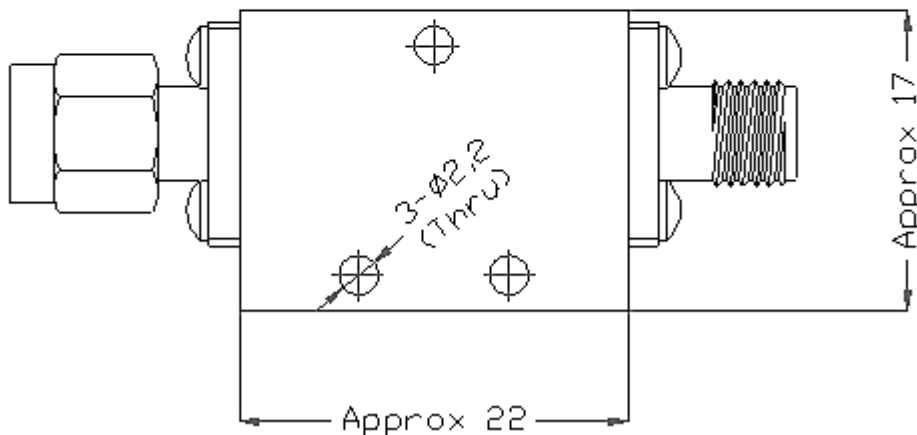

Order Examples: RLPF-DC-12.4-Sm-Sf-15W-c14

Description: (Low Pass Filter, DC-12.4GHz, SMA Male to SMA Female Connectors, 15Watts)

Specifications	
3.0dB Frequency Point	13.0 GHz
Pass Band Frequency	DC-12.4 GHz
Pass Band Insertion Loss	≤0.7 dB
Pass Band VSWR	≤1.6:1
Stop Band Attenuation	≥50dB @ 14.1-21.0GHz
Impedance	50 ohms
Power	≤15 W
Surface Finish	Guided Oxygen or Black Paint
Connectors	SMA-Male / SMA-Female