

**Coaxial Isolator, 6.0-8.5GHz
SMA Connectors, 10 Watts
RADI-6.0-8.5-S3-10WR**

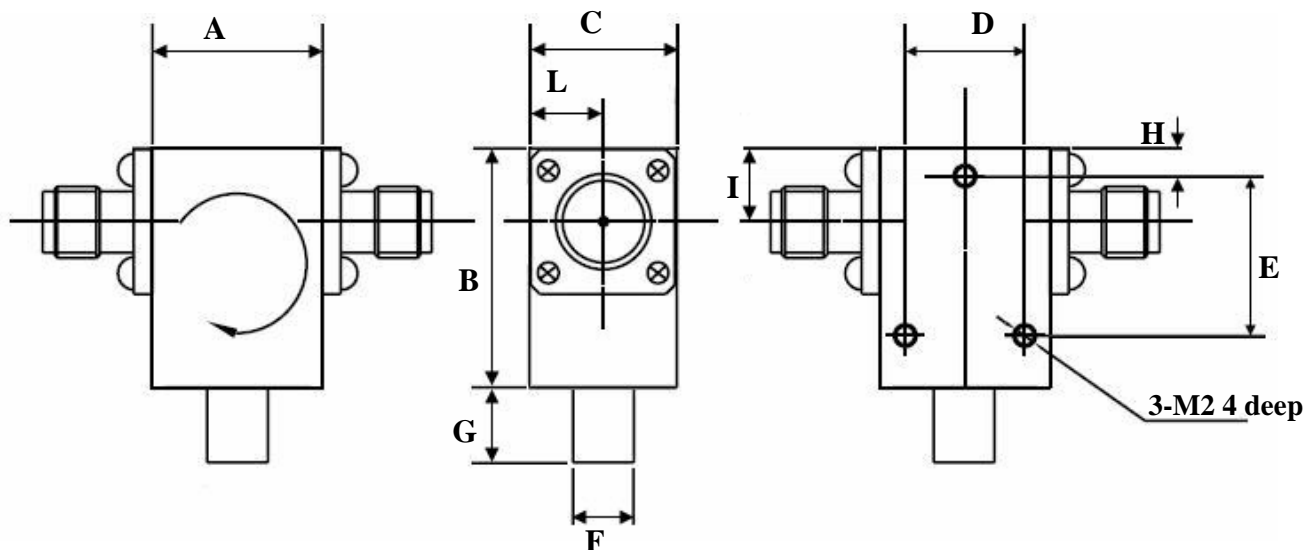

Direction of RF:	
R	Default
L	

Units: mm
Not to scale

Order Examples: RADI-6.0-8.5-S3-10WR

I=ISOLATOR / C=CIRCULATOR

N / SMA Connector options (X)				
Isolator			Circulator	
Port 1	Port 2		Port 3 Male	Port 3 Female
Female	Male	-1	-11	-21
Male	Female	-2	-12	-22
Female	Female	-3	-13	-23
Male	Male	-4	-14	-24

Size#	A	B	C	D	E	F	G	H	I	L	
1	20.0	26.0	14.0	14.0	20.0	8.0	6.0	2.5	7.0	7.0	mm
											mm

Size#	Specifications: Frequency GHz	Insertion loss dB (max)	Isolation dB (min)	VSWR :1	Power Fwd Watts	Power Rev Watts	Op. Temp °C	Connector
1	6.0-8.5	0.5	20	1.25	10	10	-30 to +70	SMA