

Coaxial Isolator, 8.4-10.2GHz, bb1 Model SMA Connectors, 30 Watts, RADI-8.4-10.2-bb1-S3-30WR

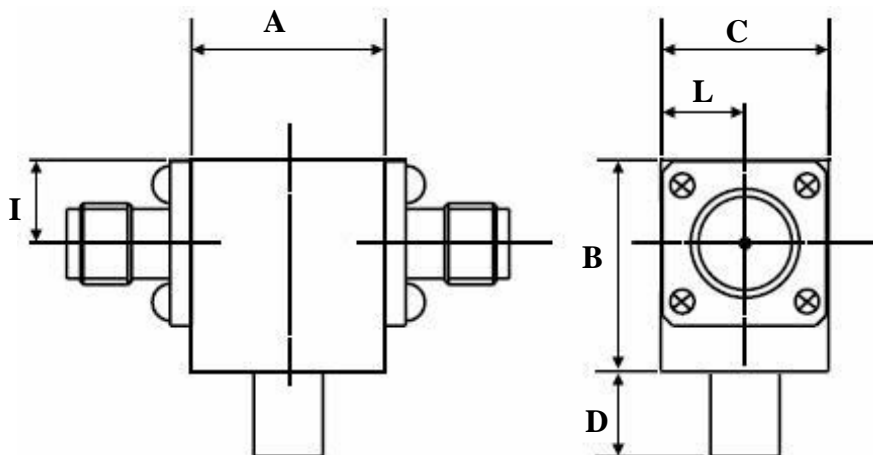

Direction of RF:	
R	Default
L	

Units: mm
Not to scale

Order Examples: RADI-8.4-10.2-S3-bb1-30WR
I=ISOLATOR / C=CIRCULATOR

N / SMA Connector options (X)				
Isolator			Circulator	
Port 1	Port 2		Port 3 Male	Port 3 Female
Female	Male	-1	-11	-21
Male	Female	-2	-12	-22
Female	Female	-3	-13	-23
Male	Male	-4	-14	-24

Size#	A	B	C	D	I	L	
1	12.7	15.75	12.7	4.8	6.41	6.35	mm
							mm

Size#	Specifications: Frequency GHz	Insertion loss dB (max)	Isolation dB (min)	VSWR :1	Power Fwd Watts	Power Rev Watts	Power Peak Watts	Op. Temp °C	Connector
1	8.4-10.2	0.4	20	1.25	30	30	350	-54 to +71	SMA
1	8.6-9.5	0.4	21	1.22	1	1		-40 to +71	SMA