

## Waveguide Isolator, 33-50 GHz, WR22 Package, UG383/U Flange, 1 or 5 Watt

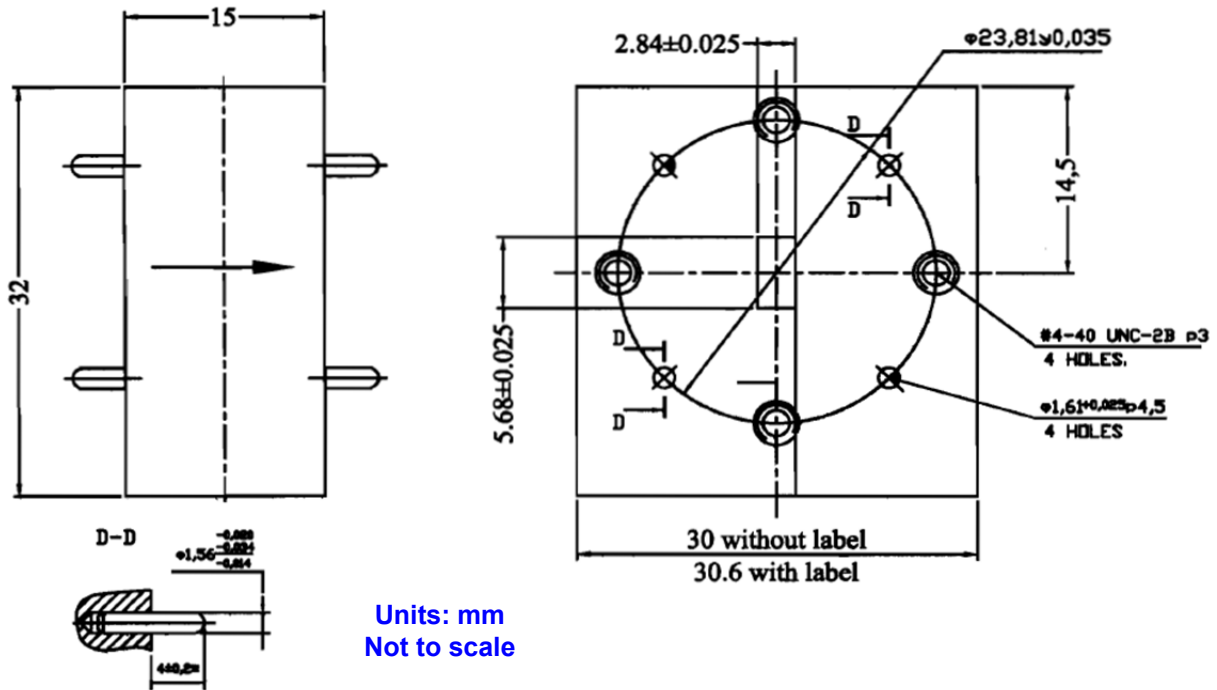

Direction of RF:	
R	Default ▶
L	◀

Order Examples: **RADI-33-50-WR22-UG383/U-5WR-1b**  
**I=ISOLATOR**

### Flange Hole Options-X

- 1 8 off 4-40 UNC 2B 0.17"(4.32) deep
- 2 4 Thru holes 0.116/.110 dia +/-0.01; (2.95+/-0.07mm)
- 3 8 off M3 x 5-6H (5 pitch, 6H thread class) x 0.280"(7.1) deep
- 4 4 x M3 0.5-6H, tanned thru

Specifications			Units
Frequency Range:	<b>33-50</b>	<b>33-50</b>	GHz
Insertion Loss	0.8	0.7	dB (max)
Isolation	13	12	dB (min)
VSWR	1.60:1	1.67:1	
Forward power	1	5	Watts
Reverse power	1	5	Watts
Waveguide	WR22	WR22	
Flange	UG383/U	UG383/U	
Temperature Range	0 to +50	0 to +50	°C