

Waveguide Isolator, 47-52 GHz WR19 Package, Square Flange, 1Watt Power, Clockwise Rotation

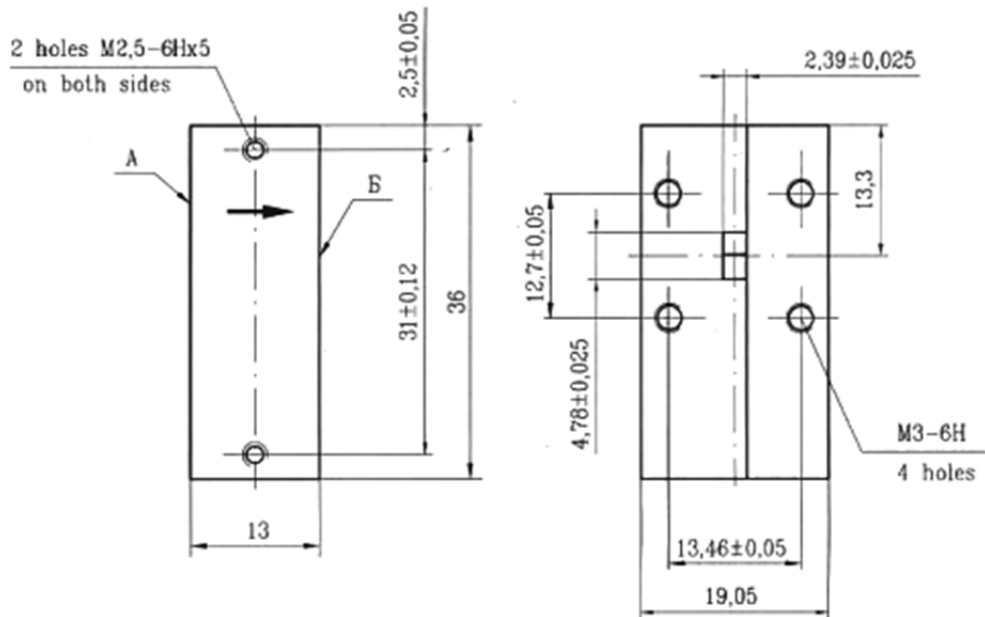

The dimensions are the same on the A, B surfaces.

Units: mm
Not to scale

Tolerance Table Metric (inch)

(unless otherwise stated):

Hole diameter +/- 0.1mm, (+/- 0.004")

Dimensions (w*h) +/- 0.3 mm, (+/- 0.015")

Dimensions (Waveguide Slot Position, +/- 0.1mm, (+/- 0.04")

Dimensions (hole position) +/- 0.1mm, (+/- 0.04")

Machined surfaces

Flatness 0.025/mm, (0.001/ inch)

Bend radius 0.8mm, (0.031" or 1/32")

Direction of RF:	
R	Default ▶
L	◀

Order Examples: **RADI-47-52-WR19-SQ-1WR-b**
I=ISOLATOR

Specifications:

Frequency GHz	Insertion loss dB (max)	Isolation dB (min)	VSWR	Reverse Power Watts	Forward Power Watts	Operating Temp °C	Waveguide/ Flange
47-52	0.4 0.5	20 18	1.25:1 1.30:1	1	1	-10 to +50 -30 to +70	WR19 / Square