

Waveguide Isolator, 55-67GHz (8 GHz Bandwidth max) WR15, UG385/U Flange, 1 Watt

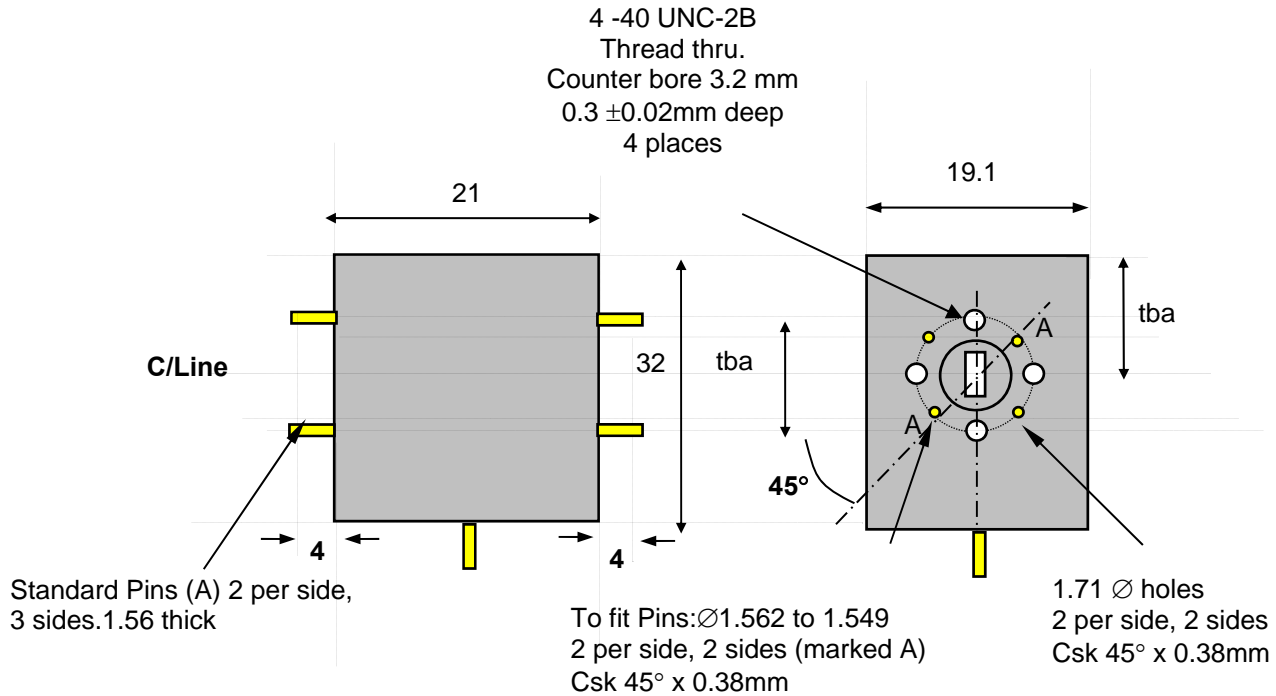

Units: mm.
Tolerance: ±0.2 unless otherwise stated.
Material: Silver plated brass.

Direction of RF:	
R	Default ▶
L	◀

Order Examples: **RADI-59-64-WR15-UG385/U-1WR-b**
I=ISOLATOR / C=CIRCULATOR

Specifications:

Frequency GHz	Bandwidth GHz	Insertion loss dB (max)	Isolation dB (min)	VSWR	Reverse Power Watts	Forward Power Watts	Waveguide Package	Operating Temp °C
55-67	8	0.4	20	1.25:1	1	1	WR-15, UG385/U	room
		0.4	18	1.30:1				-10 to +70
59-64	Full	0.45	20	1.25:1	1	1	WR-15	room
		0.50	18	1.30:1				-30 to +50